

Step by step assembly instructions

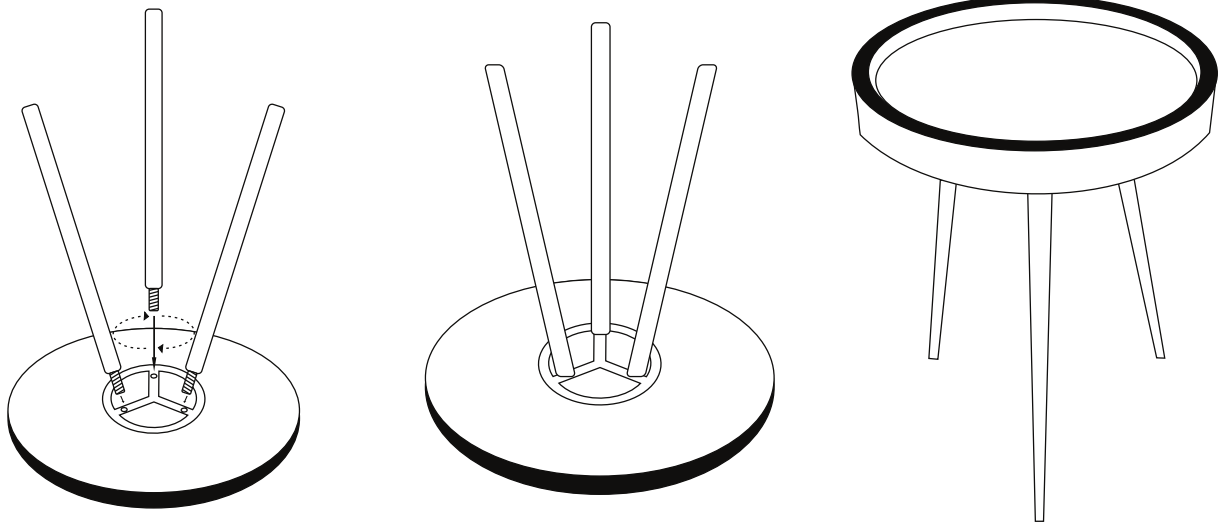

- **Step 1** : Remove all the packaging. Place the tabletop on the protected area
- **Step 2** : Take one leg and align with a hole in the table top. Turn clockwise until it first securely. Do not over tighten. Do the same with the second and third leg.

Care and maintenance

- A gentle wipe with line-free cleaning cloth is all that is required to maintain the finish. Do not use any abrasive cleaning products or spray polishes on this table, as they will alter the finish of the table.
- All spillages must be wiped up immediately.
- Furniture will endure most temperatures in the modern home. However, it should be positioned as far away from radiators or other direct heat sources as possible.
- The tables should not be used for sitting or standing on.
- Never drag pieces across the floor as this could cause damage to the floor.
- Periodically check all fixings and tighten if necessary.